

**ITEM 27. ITEM FOR COMMITTEE INFORMATION – CYCLEWAY –
LIVERPOOL STREET FROM SUSSEX STREET TO KENT STREET
SYDNEY**

TRIM RECORD NO: 2015/011910

RECOMMENDATION

It is recommended that the Committee note the following:

- (A) Reallocation of parking on the northern side of Liverpool Street between the points 7.8 metres and 65.9 metres east of Sussex Street as “No Stopping”;
- (B) Reallocation of parking on the southern side of Liverpool Street between the points 11.5 metres and 20.9 metres east of Sussex Street as “No Stopping”; and,
- (C) Installation of kerb amendments and changes to lane configuration in Liverpool Street between Sussex and Kent Streets to provide for the installation of the bus lanes and cycleways.

DECISION

BACKGROUND

On 19 December 2013, the NSW Government adopted the Sydney City Centre Access Strategy (Access Strategy). The Access Strategy will deliver a fully integrated transport network in Sydney’s City Centre that puts the customer first and meets the growing transport task. It will mean more people use public transport to access the City Centre and it will change the way people move around within it.

The Access Strategy considers all transport modes and demonstrates how light rail, buses, trains, ferries, cars, taxis, pedestrians and cyclists will interact in the heart of Sydney. The Access Strategy also provides a clear direction for how all the different transport modes will work together in the Sydney CBD to reduce congestion, provide for future growth and improve the customer experience.

The city cycleway network includes the provision of cycleways on Kent Street, Liverpool Street, Castlereagh Street and Park Street with associated amendments to lane configuration, line markings, medians and parking changes.

The city cycleway network improvements aims to provide safe and connected cyclist infrastructure routes travelling north to south and east to west throughout the city;

The cycleway infrastructure will be delivered by Roads and Maritime Services (RMS), in conjunction with Transport for New South Wales (TfNSW) and the City of Sydney.

COMMENTS

The kerb space on the southern side of Liverpool Street between Sussex and Kent Streets is generally signposted as “P Motorcycles Only” and “No Parking”.

The kerb space on the northern side of Liverpool Street between Sussex and Kent Streets is generally signposted as “P5”, “No Parking”, 1P Ticket, 4P Ticket and Loading Zone Ticket.

Liverpool Street between Sussex and Kent Streets is identified in the Access Strategy as a key cyclist corridor. The cycleway includes “No Stopping” on the northern side of Liverpool Street.

Where possible, loading, taxi and parking for people with disabilities will be distributed to neighbouring streets, contained within the proposed changes for the bus and cycleway plans.

Agreement was obtained from the RMS, the Sydney City Police and the State Member, for the proposed changes.

It is noted that the State Member commented that the design appears to put pedestrians and cyclists in conflict with each other at a number of locations and requested that RMS review the cycleways in operation to identify safety ‘hot spots’ and high risk locations where cyclists and pedestrians will be in conflict and consider improvements.

CONSULTATION

The Roads and Maritime Services carried out a letter drop consultation as well as contacting individual affected stakeholders individually in the affected area. The consultation process had 38,000 letters sent out and 127 responses in total were received. Of the above overall responses, there were 56 responses supporting the proposal and 67 responses opposing the proposal. Two neither support nor object and one was out of scope.

Submissions opposing the proposal were concerned about the loss of loading and parking spaces.

Submissions supporting the proposal believed the proposal would improve access to the City and reduce general traffic congestion.

FINANCIAL

The project is being funded by Transport for NSW and City of Sydney.

ATTACHMENTS

Item for Committee Information – Cycleway – Liverpool Street from Sussex Street to Kent Street Sydney

Stephen Sherwin, Project Manager – Roads and Maritime Services

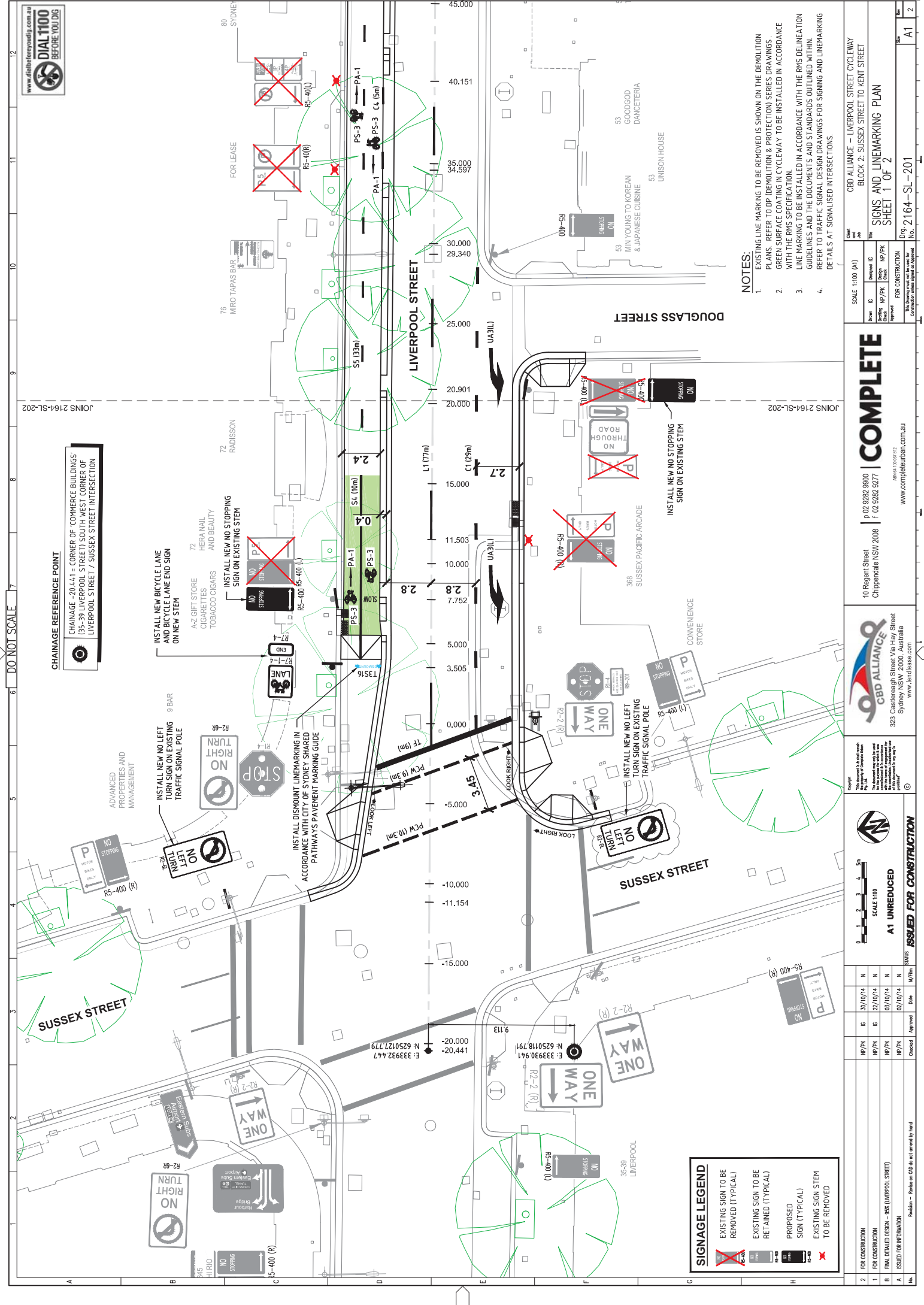

SIGNAGE LEGEND

- EXISTING SIGN TO BE REMOVED (TYPICAL)
- EXISTING SIGN TO BE RETAINED (TYPICAL)
- PROPOSED SIGN (TYPICAL)
- EXISTING SIGN STEM TO BE REMOVED

- NOTES:**
- EXISTING LINE MARKING TO BE REMOVED IS SHOWN ON THE DEMOLITION PLANS. REFER TO DP (DEMOLITION & PROTECTION) SERIES DRAWINGS.
 - GREEN SURFACE COATING IN CYCLEWAY TO BE INSTALLED IN ACCORDANCE WITH THE RMS SPECIFICATION.
 - LINE MARKING TO BE INSTALLED IN ACCORDANCE WITH THE RMS DELINEATION GUIDELINES AND THE DOCUMENTS AND STANDARDS OUTLINED WITHIN.
 - REFER TO TRAFFIC SIGNAL DESIGN DRAWINGS FOR SIGNING AND LINEMARKING DETAILS AT SIGNALISED INTERSECTIONS.

No.	2	FOR CONSTRUCTION	HP/PK	IS	30/10/14	N	Approved	Date	STATUS	ISSUED FOR CONSTRUCTION	 323 Castlereagh Street Via Hay Street Sydney NSW 2000, Australia www.cbdalliance.com.au	COMPLETE p 02 9932 9980 f 02 9932 9277 10 Regent Street Chippendale NSW 2008 www.completeurban.com.au	SCALE 1:100 (A1) Block 2: SUSSEX STREET TO KENT STREET SIGNS AND LINEMARKING PLAN SHEET 1 OF 2 Drg 2.164-SL-201
	1	FOR CONSTRUCTION	HP/PK	IC	27/10/14	N							
A		ISSUED FOR INFORMATION	HP/PK	IS	03/10/14	N							
B		FINAL DETAILED DESIGN - 90% (LIVERPOOL STREET)	HP/PK	IC	03/10/14	N							
C		ISSUED FOR INFORMATION	HP/PK	IS	02/10/14	N							

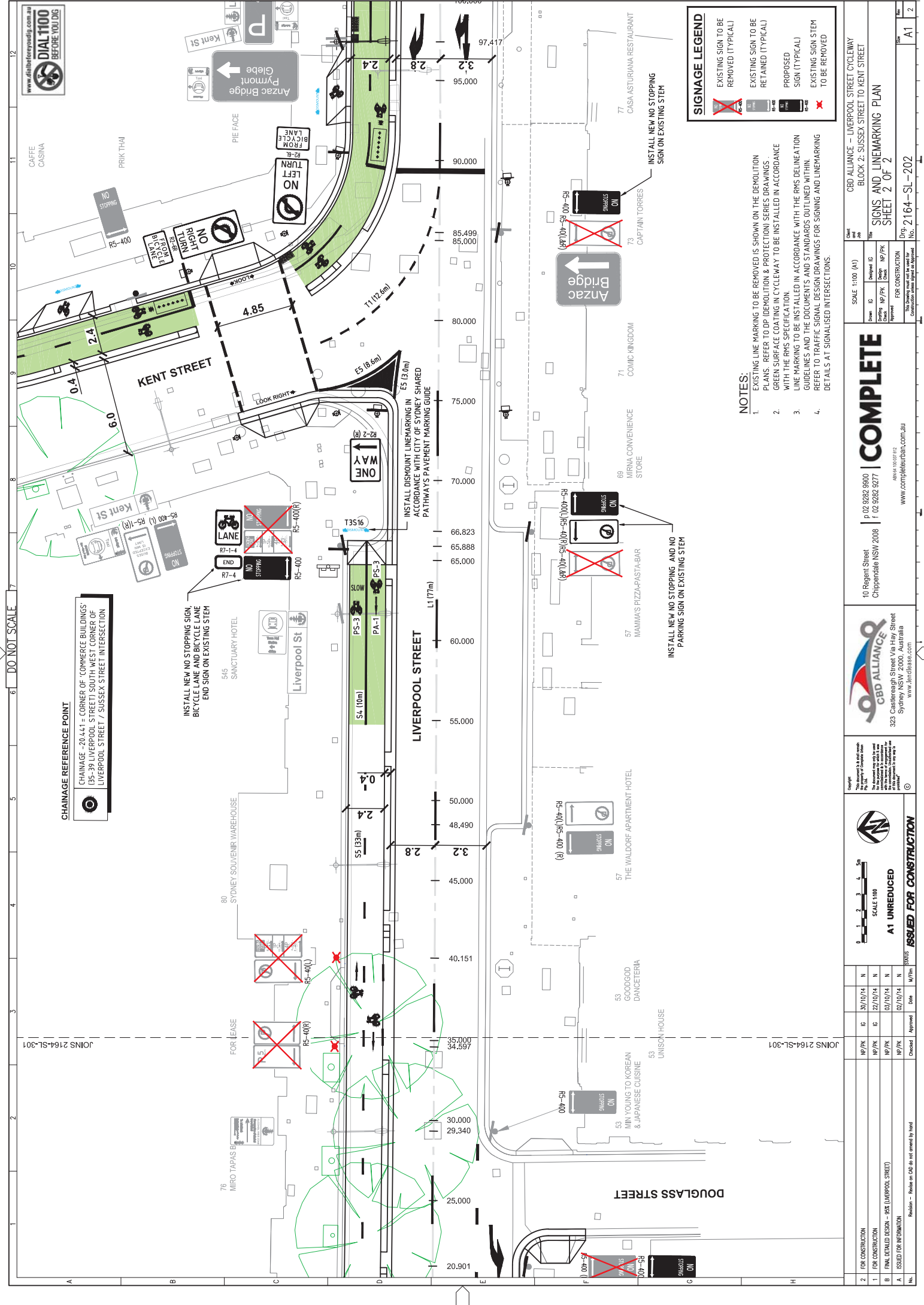

SIGNAGE LEGEND

	EXISTING SIGN TO BE REMOVED (TYPICAL)
	EXISTING SIGN TO BE RETAINED (TYPICAL)
	PROPOSED SIGN (TYPICAL)
	EXISTING SIGN STEM TO BE REMOVED

- NOTES:**
- EXISTING LINE MARKING TO BE REMOVED IS SHOWN ON THE DEMOLITION PLANS. REFER TO DP (DEMOLITION & PROTECTION) SERIES DRAWINGS.
 - GREEN SURFACE COATING IN CYCLEWAY TO BE INSTALLED IN ACCORDANCE WITH THE RMS SPECIFICATION.
 - LINE MARKING TO BE INSTALLED IN ACCORDANCE WITH THE RMS DELINEATION GUIDELINES AND THE DOCUMENTS AND STANDARDS OUTLINED WITHIN. REFER TO TRAFFIC SIGNAL DESIGN DRAWINGS FOR SIGNING AND LINEMARKING DETAILS AT SIGNALISED INTERSECTIONS.
 -

<p>10 Regent Street Chippendale NSW 2008</p> <p>COMPLETE</p> <p>www.completeurban.com.au</p>		<p>SCALE 1:100 (A1)</p> <p>DATE: 15/07/2014</p> <p>DESIGNER: [Name]</p> <p>CHECKER: [Name]</p> <p>APPROVED FOR CONSTRUCTION: [Name]</p> <p>CONSTRUCTION START DATE: [Date]</p>	<p>CBD ALLIANCE - LIVERPOOL STREET CYCLEWAY BLOCK 2 - SUSSEX STREET TO KENT STREET SIGNS AND LINEMARKING PLAN SHEET 2 OF 2</p> <p>Dwg: 2164-SL-202</p>																				
<p>Copyright: This document is a confidential document. It is not to be distributed, copied, or reproduced in any form without the prior written consent of the copyright owner.</p> <p>323 Castlereagh Street Via Hay Street Sydney NSW 2000, Australia www.tenders.com</p>		<p>0 1 2 3 4 5m</p> <p>SCALE 1:100</p> <p>A1 UNREduced</p> <p>ISSUED FOR CONSTRUCTION</p>	<table border="1"> <thead> <tr> <th>Revised</th> <th>Approved</th> <th>Date</th> <th>Status</th> </tr> </thead> <tbody> <tr> <td>HP/PK</td> <td>IC</td> <td>30/10/14</td> <td>N</td> </tr> <tr> <td>HP/PK</td> <td>IC</td> <td>27/10/14</td> <td>N</td> </tr> <tr> <td>HP/PK</td> <td>IC</td> <td>03/10/14</td> <td>N</td> </tr> <tr> <td>HP/PK</td> <td>IC</td> <td>02/10/14</td> <td>N</td> </tr> </tbody> </table>	Revised	Approved	Date	Status	HP/PK	IC	30/10/14	N	HP/PK	IC	27/10/14	N	HP/PK	IC	03/10/14	N	HP/PK	IC	02/10/14	N
Revised	Approved	Date	Status																				
HP/PK	IC	30/10/14	N																				
HP/PK	IC	27/10/14	N																				
HP/PK	IC	03/10/14	N																				
HP/PK	IC	02/10/14	N																				